

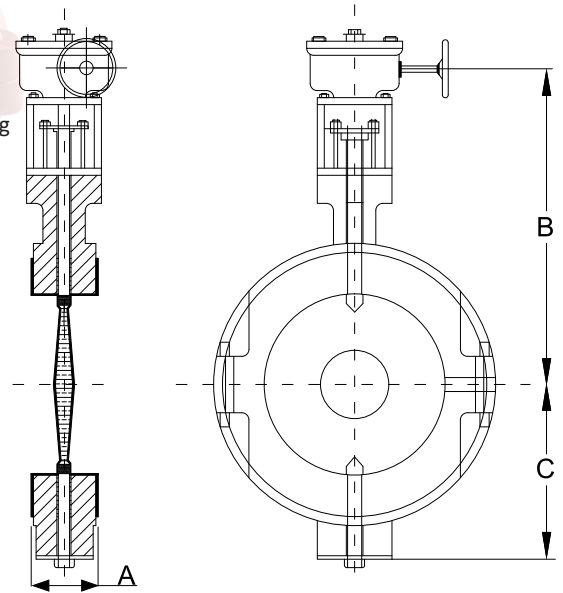

# V-Line

## 3GBFV02 LINED BUTTERFLY VALVES

- **Size**
  - 2" – 14" Class: PN 6/PN 10/PN 16/Class 150
  - End Connection: Lug/Wafer/Flanged.
  - Operation: Lever/Gear Operated/Electrical Actuator/Pneumatic Actuator.
- **PFA LINED BUTTERFLY VALVES**
  - A butterfly valve is a valve which can be used for isolating or regulating flow.
  - The closing mechanism takes the form of a disk.
  - Operation is similar to that of a ball valve, which allows for quick shut off.
- **Features & Benefits**
  - One of the most important feature of the 3G Butterfly valve is the stem seal.
  - The pressure to keep the two sealing surfaces together is provided by an upper and lower set of Cup & Cone Packing's resulting in a superior stem seal.
  - The elastomer back-up pads behind the liner ensure a tight fit around the disc, giving a bubble tight shut-off at minimum operating torque.
  - The liner provides a wide flange sealing surface.
  - The liner and disc are the only two valve parts in contact with the medium.
  - Primary shaft sealing by preloaded contact between disc and liner hub.
  - Secondary shaft seal by oversizing the shaft diameter in relation to the shaft hole in the liner.
- **The liner and disc are molded and machined to close tolerances to provide:**
  - Low torque
  - Less stress and deformation during opening and closing
  - Elimination of tearing and bunching
  - An integrated part of the primary and secondary sealing in the shaft area
  - Optional TFM lining available for extremely demanding applications.
  - Integral body locating holes to ease installation and to ensure perfect centering of the valve between flanges.
  - Actuator Mounting flange dimensions according to ISO 5211.
  - Anti blow-out shaft provision.

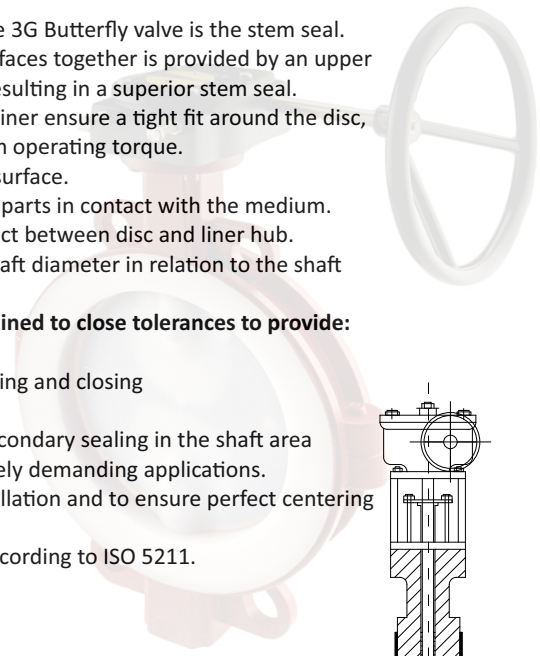

TECHNICAL SPECIFICATION	
Design Standard	API 609 Wafer Type
Face to Face	API 609 Category 'A'
Flange End	ANSI B 16.5 150#
Testing Standard	API 598/ISO 9398-2/BS EN 12266-1
Lining Material	PFA/FEP,PTFE
Lining Thickness	3 to 5mm
Body MOC & TRIM	Stainless Steel, Carbon Steel
Operation	Manual Lever, Gear Box, Acuator

\* Dimensional drawing available on request.